

# Vertigo Steatite

SPACE & ENERGY-SAVING WATER HEATER  
WITH PREMIUM FLAT DESIGN

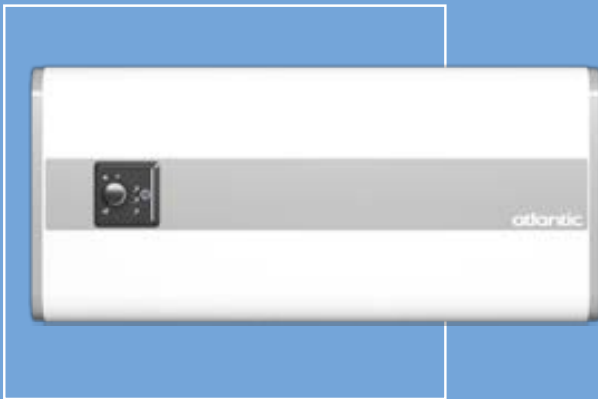

## + PRODUCT

### COMFORT

- Compact design, ideal for small dwellings
- High performance, energy saving
- Ultra-quiet operation, ideal for laundries
- Premium flat design

### QUALITY - DURABILITY

- High quality materials, long life expectancy
- Ultra-quiet operation, ideal for laundries
- Premium flat design
- High performance, energy saving
- Ultra-quiet operation, ideal for laundries
- Premium flat design

### POWER REQUIREMENTS

- High performance, energy saving
- Ultra-quiet operation, ideal for laundries
- Premium flat design

High performance, energy saving

### USER-FRIENDLINESS

- High performance, energy saving
- Ultra-quiet operation, ideal for laundries
- Premium flat design

### SAVINGS

- High performance, energy saving
- Ultra-quiet operation, ideal for laundries
- Premium flat design

## ELECTRIC WATER HEATER

25 TO 80 L (MULTI-POSITION INSTALLATION)



Model available\*\*



Digital interface



Energy savings

MAGNESIUM ANODE

Tank protection



Dry ceramic heating element

\*Not available for Vertigo Steatite 30 (25 litre)

\*\*D: Multiposition installation

# Vertigo Steatite

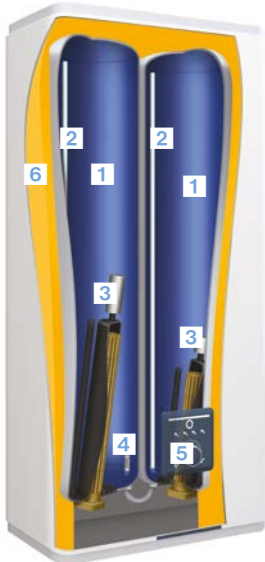

- 1 Diamond-quality enamel (glass-lined inner tank)
- 2 Optimised stainless steel outlet pipe
- 3 Double Steatite dry heating element with magnesium anode
- 4 Inlet diffuser
- 5 Digital interface
- 6 High-density polyurethane foam 0 % CFC



- 1 Heating light indicator
- 2 Boost mode\*: quick heating in order to recover 1 shower in less than 30 min
- 3 Shower-ready indicator showing quantity of hot water remaining (fixed) or being produced (blinking)
- 4 Manual mode: Manual selection of hot water quantity
- 5 Anti-frost mode (7°C)
- 6 Manual selection (from 50°C to 70°C max)
- 7 Smart mode: Automatic operation according to consumer habits thanks to a self learning program
- 8 Quick mode selection control knob

Thanks to the unique Steatite technology, the water heater is well adapted to aggressive, hard and desalinated water. Ceramic heating element is protected by enamelled steel sleeve, which grants a large heat exchange surface and reduces limescale deposits.

## INSTALLATION DIMENSIONS

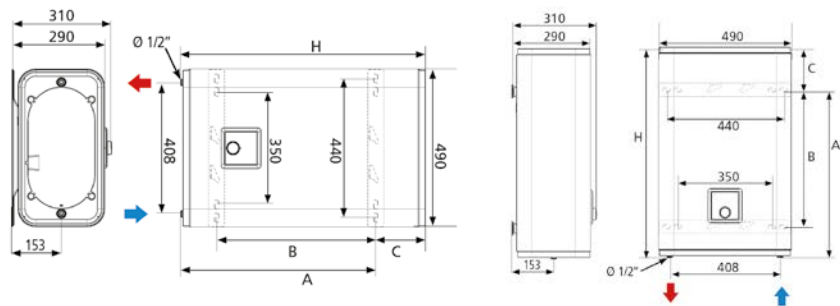

Allowance of approx. 300mm is required for plumbing from cold water inlet & hot water outlet as well as the plumbing cover (if used). Request a copy of our hydraulic setup diagram for more information.

## TECHNICAL DATA

MODEL	CAPACITY (L)	MAXIMUM POWER OUTPUT (W)	POWER OUTPUT EXIT TANK (W)	POWER OUTPUT ENTRY TANK (W)	TOTAL HEAT-UP TIME ΔT=50°C	HEAT-UP TIME EXIT TANK (WITHOUT BOOST)
Vertigo Steatite 30	25	1000	1000	1000	1h32	0h46
Vertigo Steatite 50	40	2250	1500 + 750	1000	2h02	0h49
Vertigo Steatite 80	65	2250	1500 + 750	1000	3h19	1h19
Vertigo Steatite 100	80	2250	1500 + 750	1000	4h04	1h38

## DIMENSIONS

MODEL	HEIGHT (H)	WIDTH (W)	DEPTH <sup>(1)</sup> (D)	DIMENSIONS (mm)			NET WEIGHT (Kg)	PROFILE
				A	B	C		
Vertigo Steatite 30	600	490	290	435	280	165	20.5	Small
Vertigo Steatite 50	765	490	290	610	500	155	24.5	Medium
Vertigo Steatite 80	1090	490	290	975	700	115	32.5	Medium
Vertigo Steatite 100	1300	490	290	1185	800	115	37.5	Medium

(1) Without wall plates

\*Not available for Vertigo Steatite 30 (25 litre)